

Bar Counter Divider

**Works with 1/2" to 1-3/4" thick counter surfaces*

page 1 of 2

ASSEMBLY INSTRUCTIONS

READ ALL INSTRUCTIONS BEFORE YOU BEGIN. DO NOT JUMP AHEAD OF ANY STEP.

PARTS LIST:

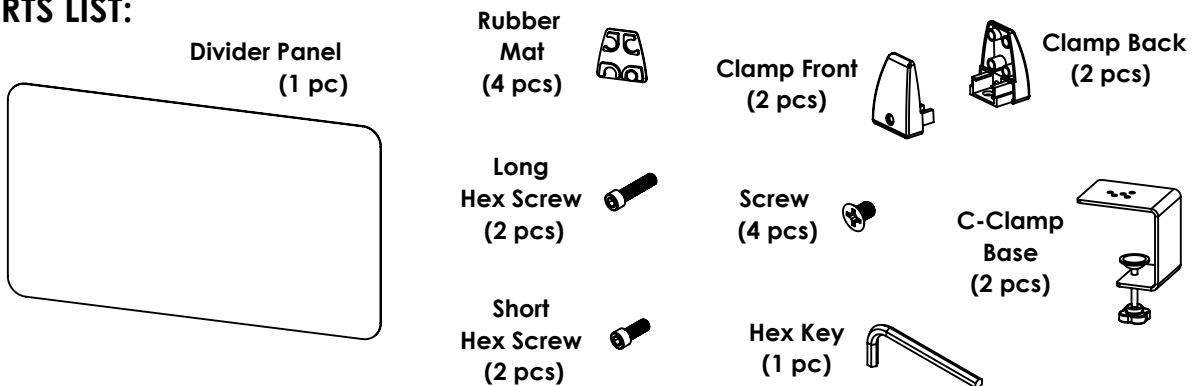

***TWO PERSON ASSEMBLY RECOMMENDED**

***TOOLS REQUIRED: PHILLIPS HEAD SCREWDRIVER (NOT INCLUDED); HEX KEY (INCLUDED)**

STEP 1: Insert Rubber Mats into Clamp Fronts and Clamp Backs.

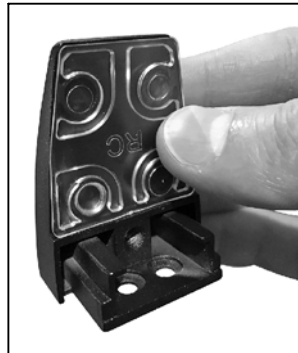
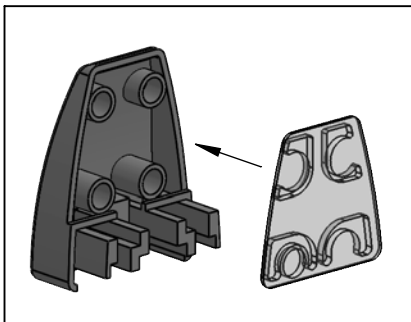

STEP 2: Attach one of the Clamp Backs to the top of a C-Clamp Base using 2 of the supplied screws. Align holes in bottom of Clamp Back with holes on top of C-Clamp Base as noted at right and below.

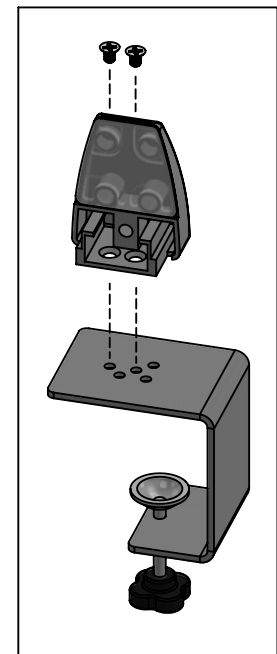

NOTE: There are multiple hole locations in top of C-Clamp Base. Please use highlighted holes when mounting Clamp Back to C-Clamp Base.

Screw into highlighted holes



STEP 3: Screw Clamp Back to C-Clamp Base.

STEP 4: Slide one of the Clamp Fronts into track in installed Clamp Back. Then insert one of the Short Hex Screws into hole in Clamp Front.

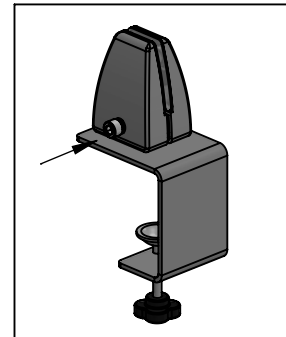
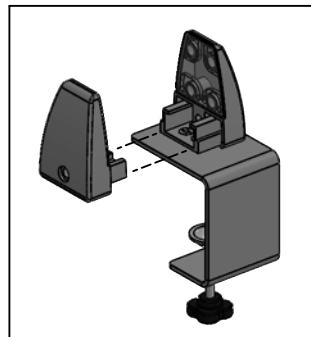

STEP 5: Repeat STEPS 2 - 4 to install remaining Clamp Back and Front onto other C-Clamp Base.

Bar Counter Divider

page 2 of 2

ASSEMBLY INSTRUCTIONS

READ ALL INSTRUCTIONS BEFORE YOU BEGIN. DO NOT JUMP AHEAD OF ANY STEP.

STEP 6: Take one of the assembled Clamps and slide C-Clamp over edge of Bar Counter/tabletop. Secure Clamp to countertop by turning knob until unit fits snug to bottom of counter.

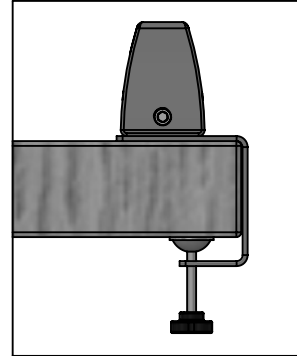
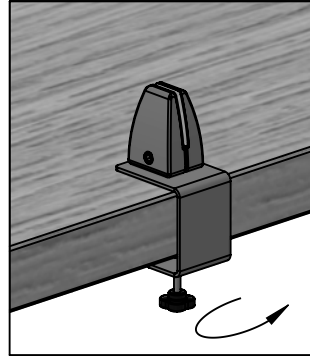
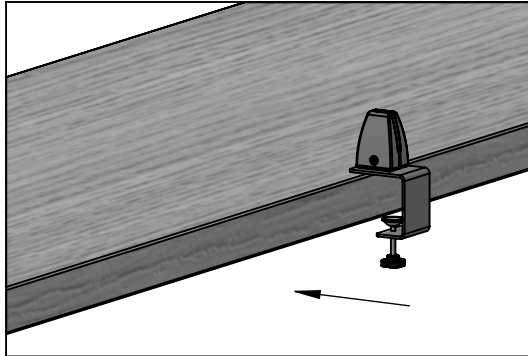

STEP 7: Repeat STEP 6 to install your other assembled Clamp on opposite side of Bar/table.

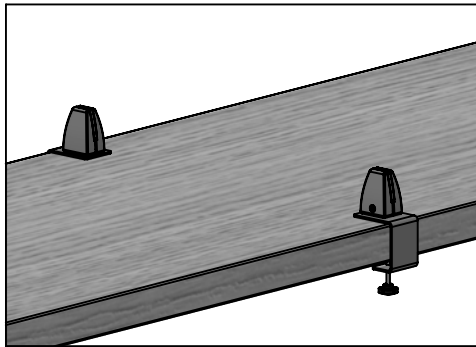

STEP 8: Peel off the protective plastic film from both sides of Divider Panel and then carefully guide Divider Panel down into opening in top of Clamps.

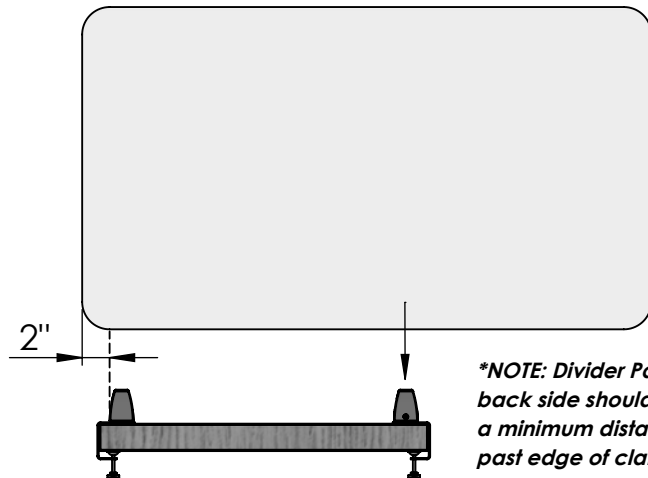

STEP 9: While one person supports the Divider Panel, have the other person use supplied Hex Key to tighten Hex screws in Clamps until Panel is snug.

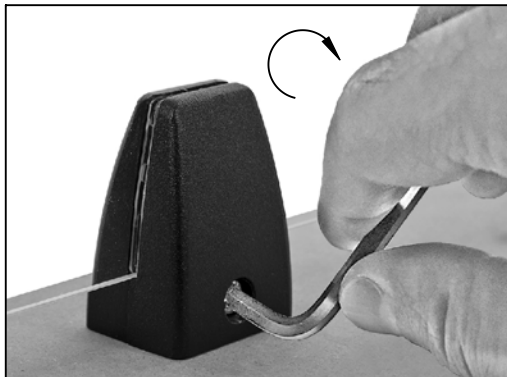

ASSEMBLY COMPLETED

