

#18001 Portable Wooden Floor Standing Display with Configurable Shelves, Hooks, Pegs

page 1 of 4

ASSEMBLY INSTRUCTIONS

READ ALL INSTRUCTIONS BEFORE YOU BEGIN. DO NOT JUMP AHEAD OF ANY STEP.

PARTS LIST:

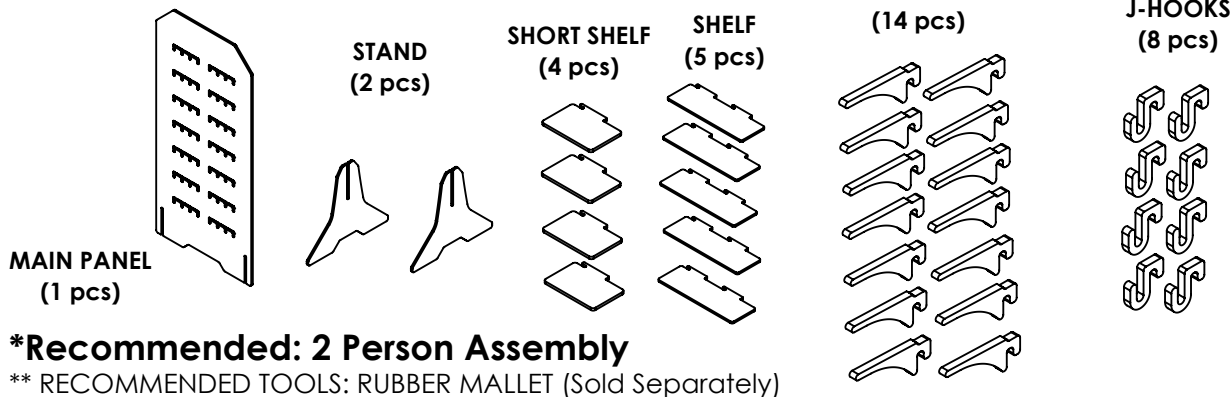

STEP 1: On an even flat surface stand both Stand pieces upright, as shown below. While holding the Stand pieces upright, simultaneously slide the vertical slots of the Main Panel into the corresponding slots in each Stand. *Note: If needed, using a rubber mallet (sold separately), gently tap the parts into place.*

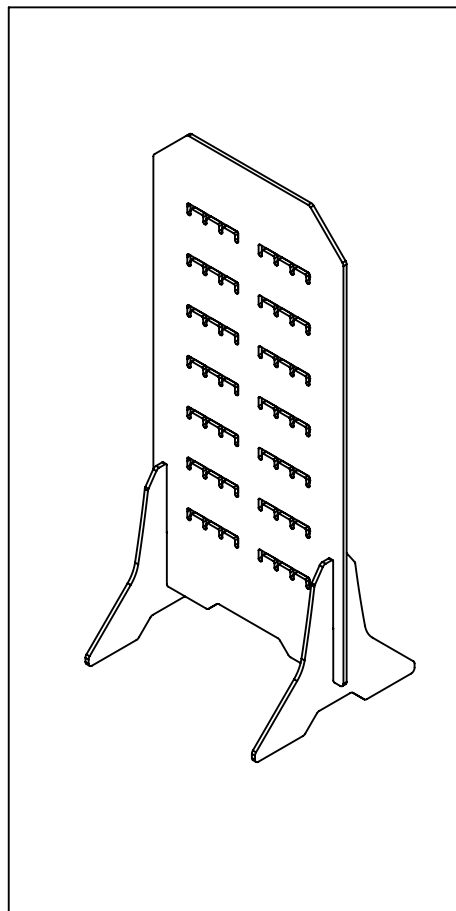
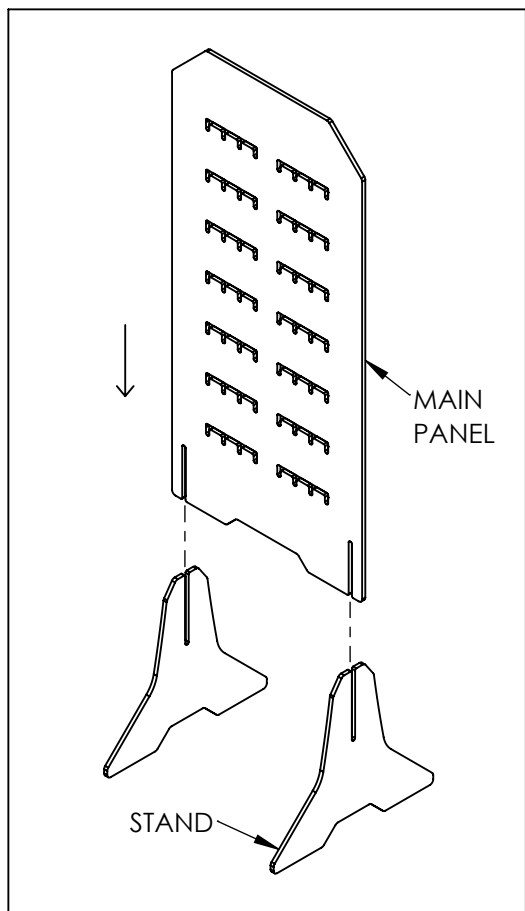

#18001 Portable Wooden Floor Standing Display with Configurable Shelves, Hooks, Pegs

page 2 of 4

ASSEMBLY INSTRUCTIONS

READ ALL INSTRUCTIONS BEFORE YOU BEGIN. DO NOT JUMP AHEAD OF ANY STEP.

STEP 2: Insert Short Shelves, Shelves, and J-Hooks into desired locations using instructions below.

SHORT SHELF INSTALLATION:

1. Insert a Shelf Peg Support into the center vertical slot under the desired location of the short shelf, as shown below.

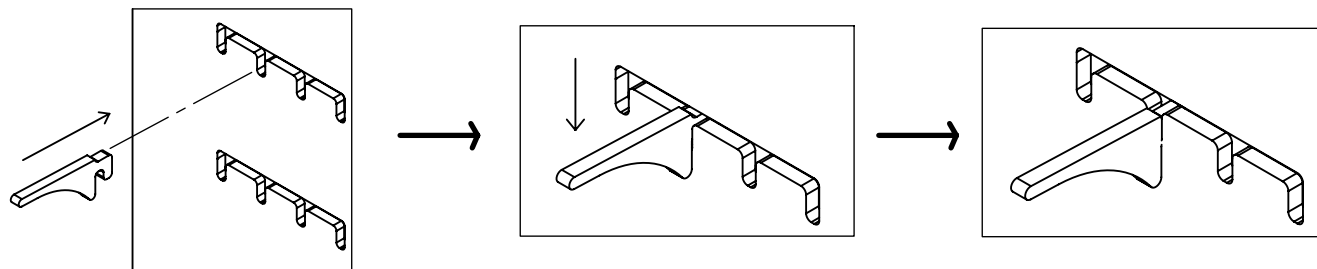

2. Insert the tab of the Short Shelf into the desired slot on the Main Panel above where the Shelf Peg Support was just inserted, as shown below.

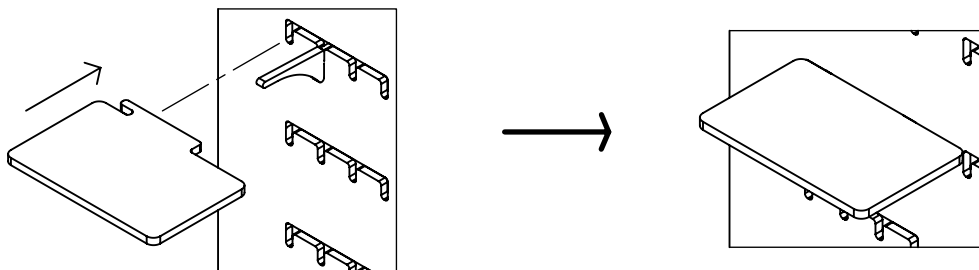

3. Slide the tab of the Short Shelf horizontally such that the hook end of the tab engages the Main Panel, as shown below.

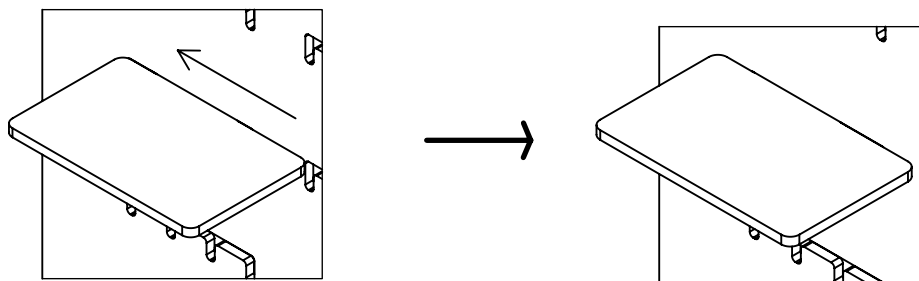

#18001 Portable Wooden Floor Standing Display with Configurable Shelves, Hooks, Pegs

page 3 of 4

ASSEMBLY INSTRUCTIONS

READ ALL INSTRUCTIONS BEFORE YOU BEGIN. DO NOT JUMP AHEAD OF ANY STEP.

SHELF INSTALLATION:

1. Insert **two** Shelf Peg Support (one each) into the leftmost and rightmost vertical slots under the desired location of the short shelf, as shown below.

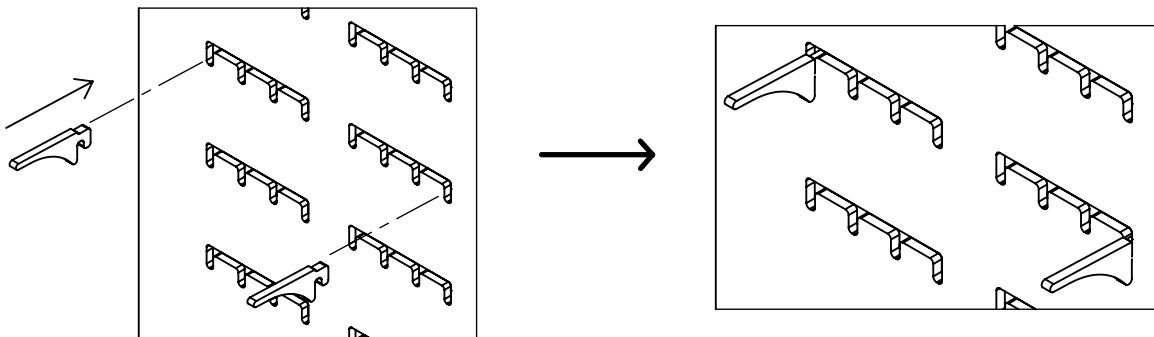

2. Insert the tab of the Shelf into the desired slot on the Main Panel above where the Shelf Peg Supports were just inserted, as shown below.

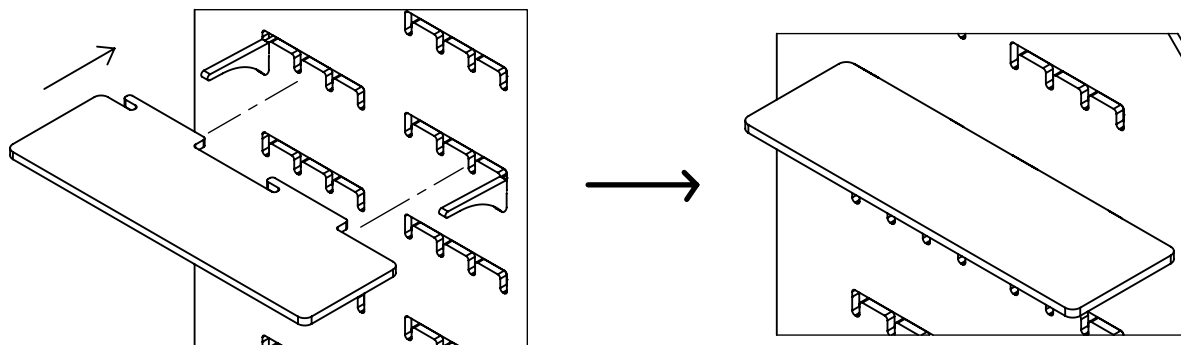

3. Slide the tabs of the Shelf horizontally such that the hook end of the tab engages the Back Wall, as shown below.

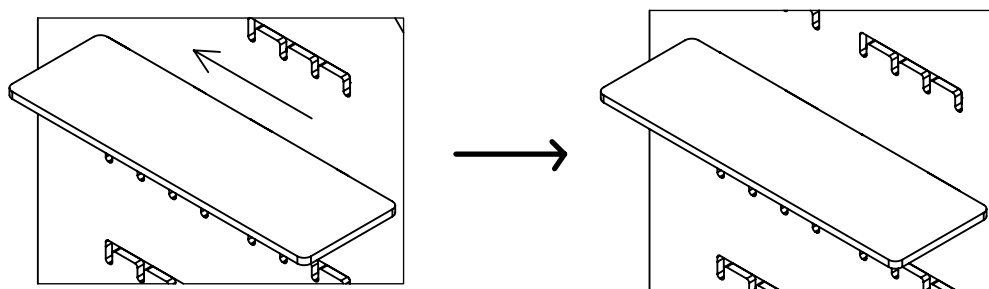

#18001 Portable Wooden Floor Standing Display with Configurable Shelves, Hooks, Pegs

page 4 of 4

ASSEMBLY INSTRUCTIONS

READ ALL INSTRUCTIONS BEFORE YOU BEGIN. DO NOT JUMP AHEAD OF ANY STEP.

J-HOOK INSTALLATION:

1. Insert a J-Hook into the desired vertical slot on the Main Panel, as shown below.

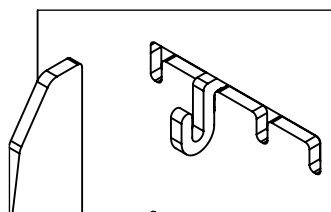
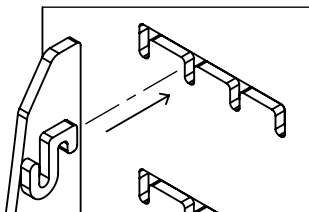

2. Slide the J-Hook downwards such that the hook on the back of the part engages the Back Wall, as shown below.

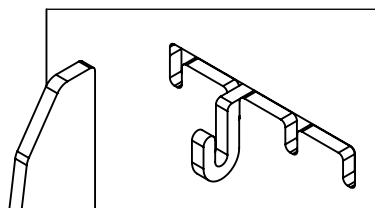
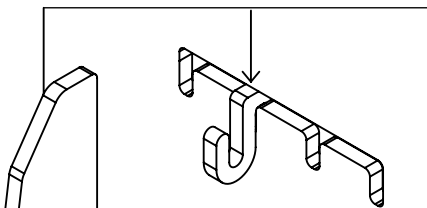

ASSEMBLY COMPLETED

